

### Application

Suitable for interior top hung sliding doors.

Ideal for residential situations where economy is of major importance.

Suitable for a single door or for two doors on a bi-parting installation - door width limits apply.

The track is sidewall fitted with provision for a 'hook-on' pelmet.

All screws are the same size and length for quick selection and easy installation.

### Door Specification

#### Track System: Sprintline 30

For Individual Doors:	
Max Door Weight	30kg
Max Door Width	1500mm
Min Door Thickness	25mm

Suitable for use with lightly constructed timber framed doors of flush or panelled construction.

Provision must be made for fitting the hangers securely, since the hangers strike the door stops.

### Standard Sets and Packs

Sets comprise top track, hangers, door stops, guide, all screws and installation instructions.

Set No.	Max door width	Track Length
SL30-16/1	900mm	1600mm
SL30-24/1	1500mm	2440mm

#### Pack No.

SL30-1PK The SL30-1PK is a pack of fittings only, without track, for use with one SL30-24/1 set for bi-parting doors, each 720mm maximum width.

### Hardware Specification

<b>Track:</b>	169
Material	Aluminium
Standard lengths	1600mm and 2440mm
Track includes recess for 'hook-on' pelmet.	

#### Hanger (2 per door): 168

The steel hanger is zinc plated and includes a nylon tyred ballrace wheel for smooth operation. Enables an easy finite door height adjustment with a door hanging.

#### Door Stop: 163

The steel door stop is zinc plated and includes a rubber buffer. The multiple holes in the plate and the fact that the buffer is reversible, allows precise adjustment for stopping the door.

#### Guide: 55G

Guide in white nylon, comes in two parts that fit on both sides of the door. The guide is floor mounted.

#### Accessories:

**Pelmet 170**  
Pelmet in pearl white on aluminium. Hooks onto track, no screws required. Supplied with End Caps. Available in 1800mm and 3050mm lengths.

#### End Caps 170C

Made from high impact polystyrene. The End Caps are a push-fit onto the pelmet.

#### Alternative Guide 102WA

Guide in zinc plated steel, has lateral adjustment. Fits on the wall or architrave, in the overlap area, and slides through a 20mm deep by 5mm wide sawcut in the bottom rail of the door. Floor left free of hardware.

#### Alternative Guide 103WA

Guide in white nylon, fits on the wall or architrave, in the overlap area, no need to groove the door, since the guide supports the door faces. The guide is adjustable for doors from 35mm to 45mm thick. Floor left free of hardware.

#### Alternative Guide 101N

The nylon guide is designed to slide through a 20mm deep by 5mm wide sawcut in the bottom rail of the door. The guide is fitted on the floor at the edge of the opening in the overlap area. The guide has lateral adjustment.

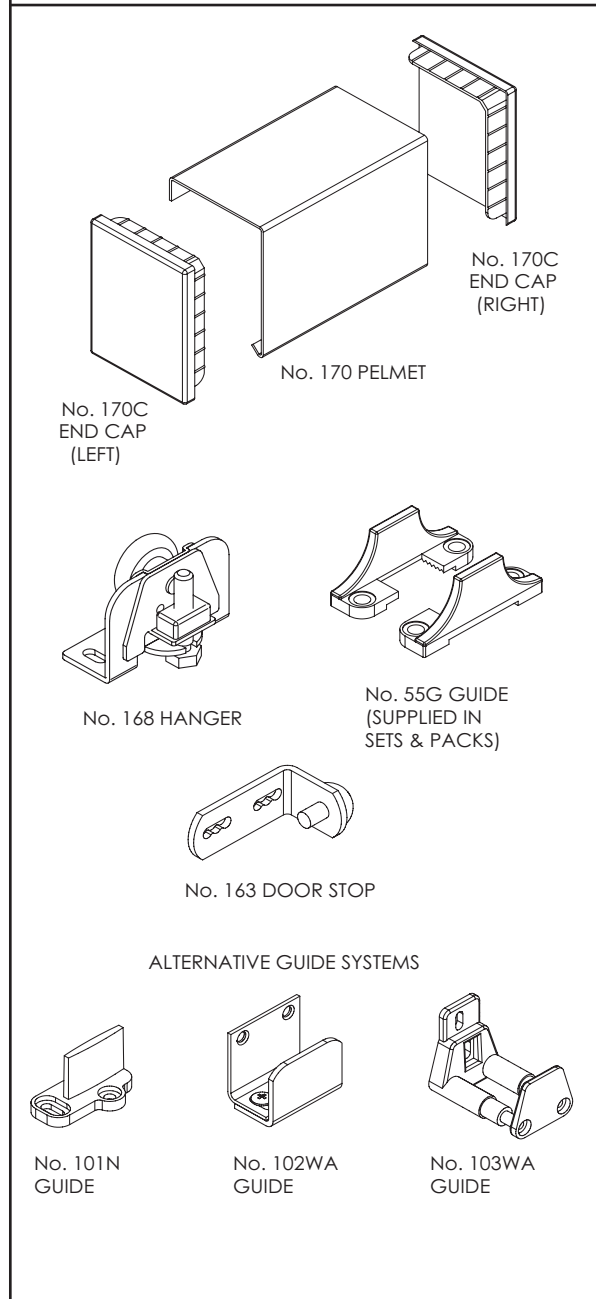
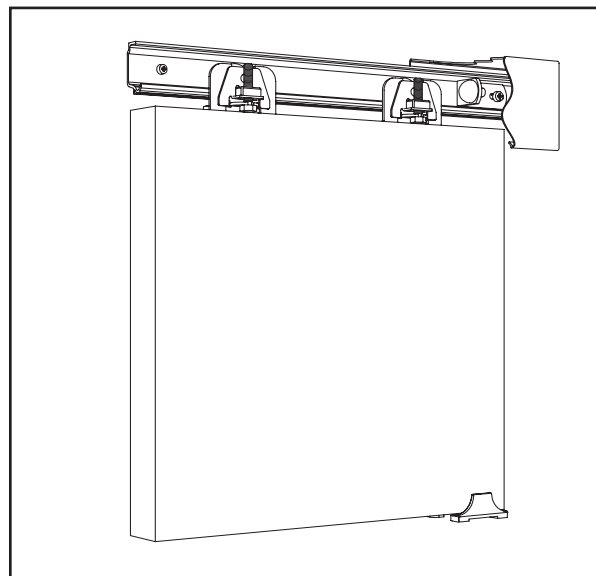

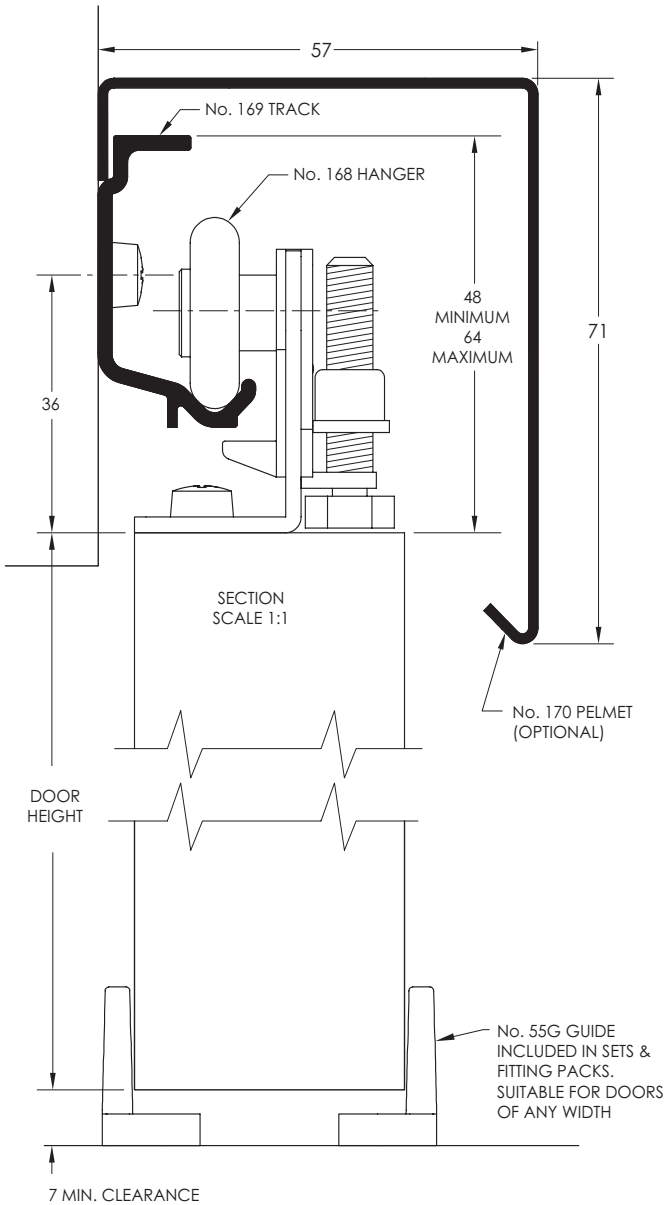

**INSTALLATION INSTRUCTIONS**

NOTE: All screws are the same type, size and length for quick installation. (Plus 4x6g screws for guide)

**1 Fit Track Parallel to Floor**

Add 36mm and required floor clearance to door height. This is the distance between finished floor and track screws. Position centre of Track directly in line with opening jamb. Screw Track to wall using pre-punched holes.

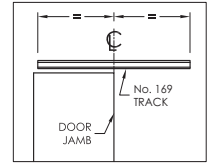

**2 Fit Hangers to Door**

Hanger Bracket should be positioned flush with inner face of door. Measurement 'X' for doors up to 1370mm equals 1/6 of door width. Over 1370mm measurement 'X' equals 340mm. For Bi-Parting doors 720mm wide, fix outside hangers 220mm from edge of door and inner hanger 15mm from edge of door.

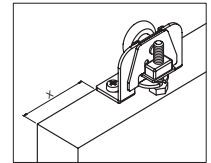

**3 Lift Door on to Track**

Lift door at an angle, wheels towards track. Hook hanger onto track and straighten door. Loosen screws of Hanger Bracket to adjust side clearance.

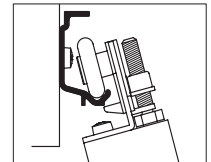

**4 Adjust Door**

Screw adjustment bolt of Hanger to adjust door height. Adjust door height so door is square.

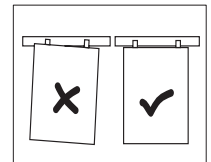
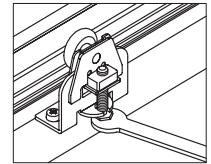

**5 Fit Door Guide**

Locate at opening jamb. With door hanging plumb fix guides to either side of door.

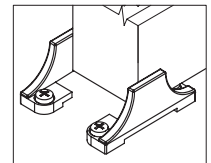

**ALTERNATIVE GUIDE SYSTEMS**

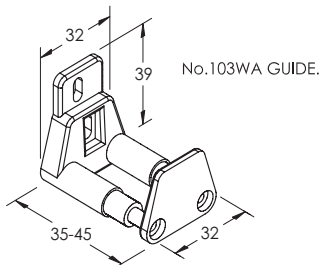
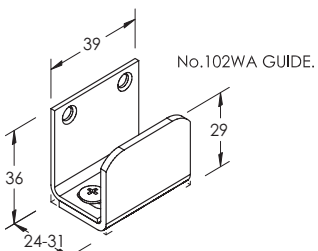
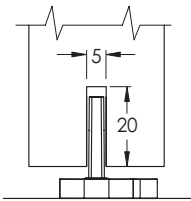
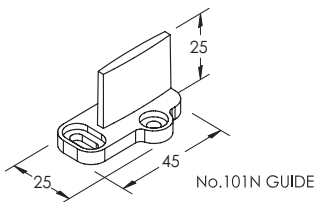
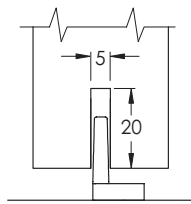
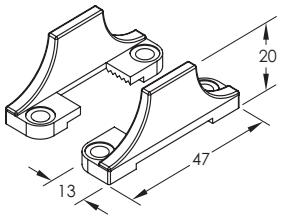

**6 Position Door Stops**

Fit one stop to each end of the Track, screw through Track. With doors over 765mm on SP3 reverse the buffer so that the door will open fully.

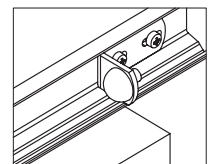

**7 Pelmet - Optional Extra**

The Pelmet hooks onto the Track and End Caps simply "Push Fit" into position.

(Note: For panels over 20kg additional screw fixings may be added between each existing hole. Screws not supplied.)

