

Screw-on railing

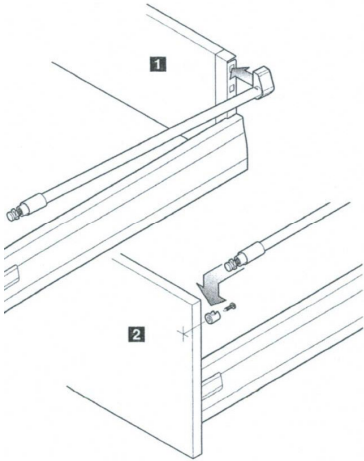

Inclination adjustment

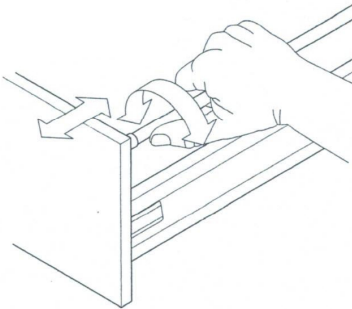

Drawer front fixing

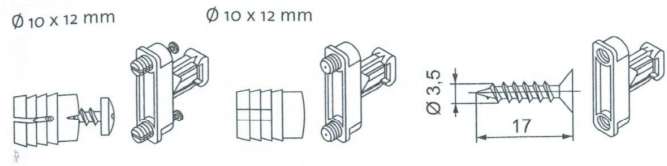

Mounting tips:
Front fixing with press-in dowel

When using front fixing brackets with press-in dowel the bored holes should be countersunk. Hard surface coatings such as Melamine can shear off the dowel membranes. This will result in a drastically reduced holding power of the bracket. As an alternative a front fixing bracket with expanding dowels can be used. For expanding dowels no countersink is needed. These dowels offer best holding power.

Drawer mounting

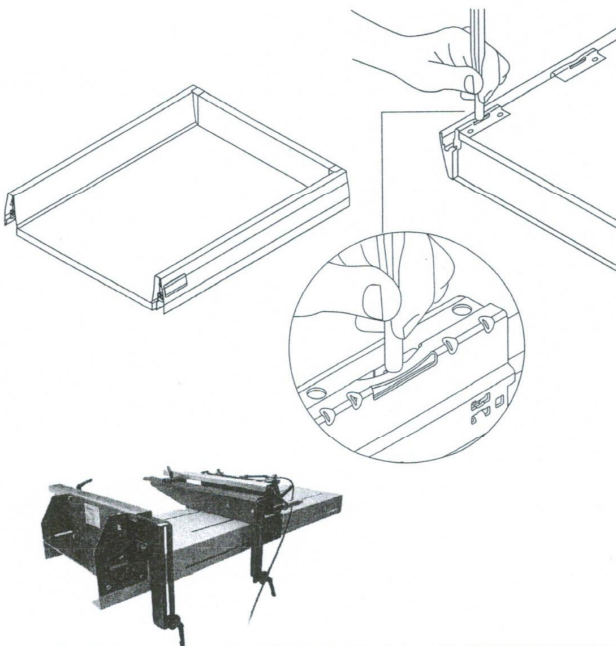

Cabinet member boring

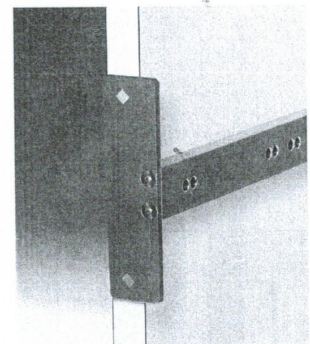
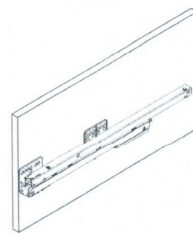

Drawer front boring

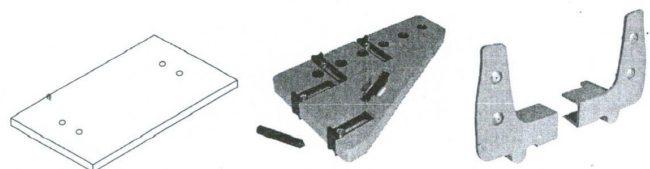

Drawer

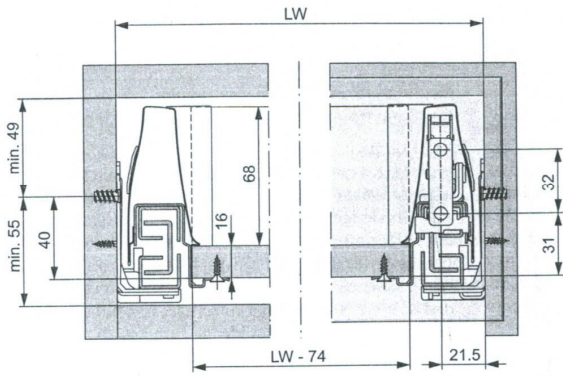
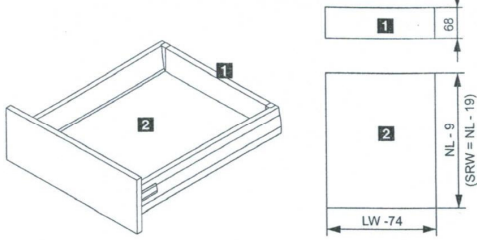

Inset drawer

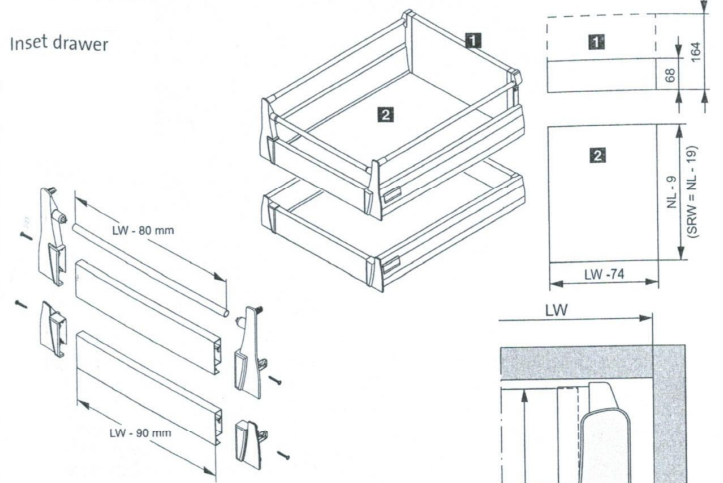

Set back for slide

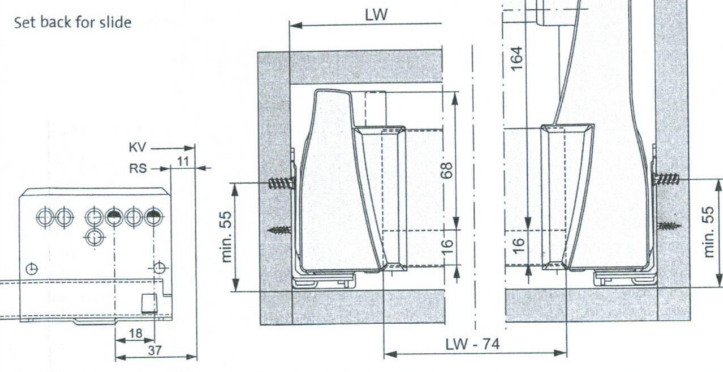

Drawer with Railing

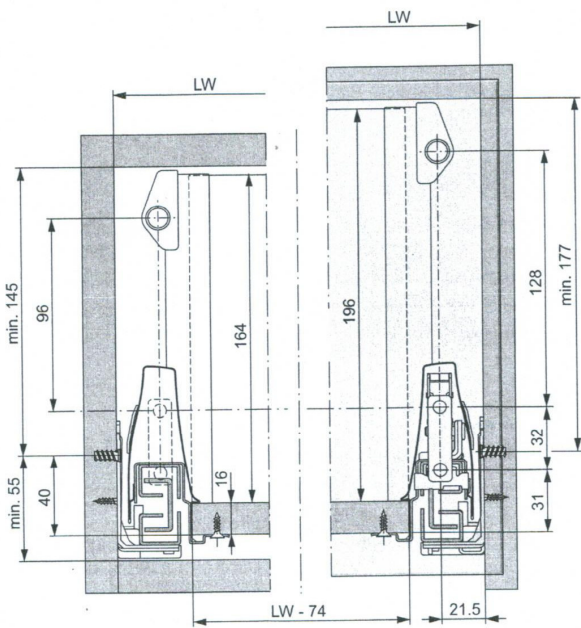
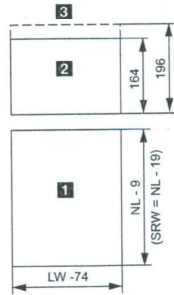

• Railing – Adapter for wooden drawer H 214 mm

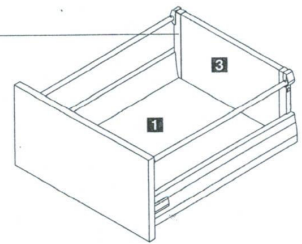

• Railing – Adapter for wooden drawer H 182 mm

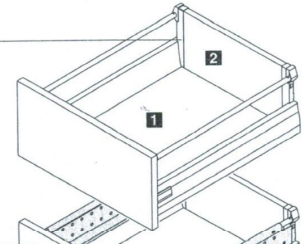

• Single wall add-on system

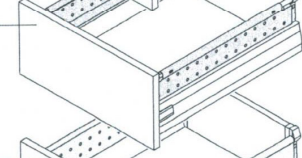

• Double wall add-on system

(H 182 mm)

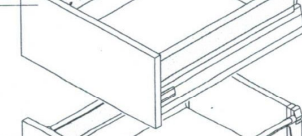

• Glas add-on system

(H 182 mm)

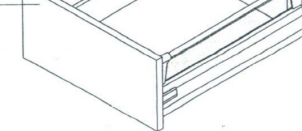

Mounting positions for cabinet profiles

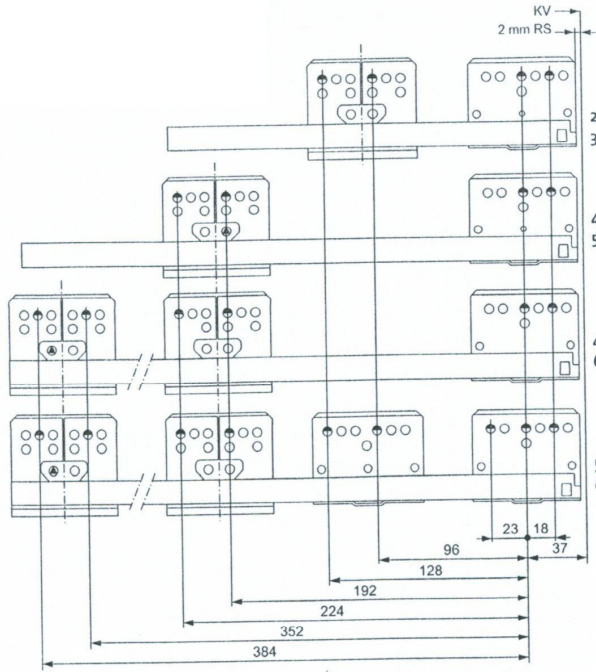

- for 40 kg full extension runners
- for 60 kg full extension runners
- for 80 kg full extension runners

Recommendation: From a carcass width of 800 mm onwards use a 60 kg / 80 kg full extension slide.

- Euro screws $\varnothing 6,3 \times 14 \text{ mm}$
- Wood screws $\varnothing 3,5 \times 15 \text{ mm}$

Dynamic XP 40 kg

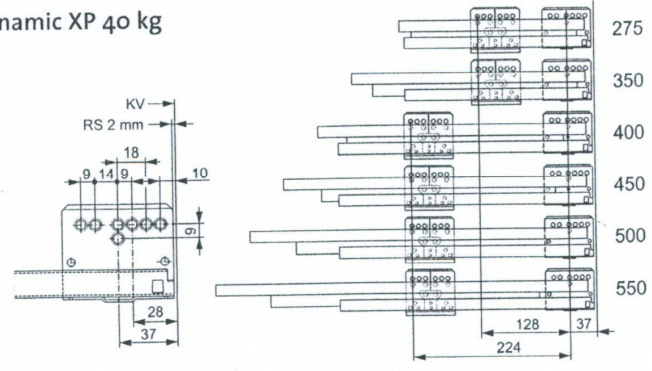

Dynamic XP 80 kg

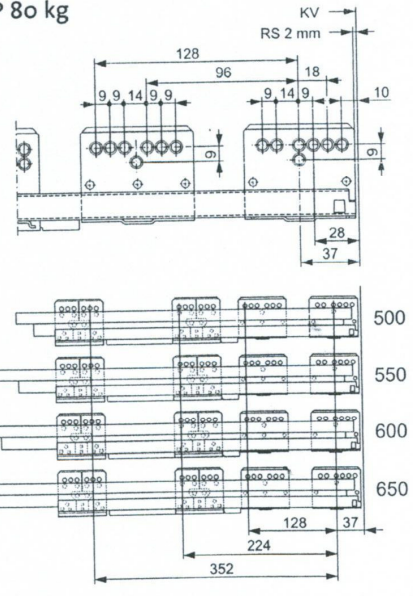

Dynamic XP 60 kg

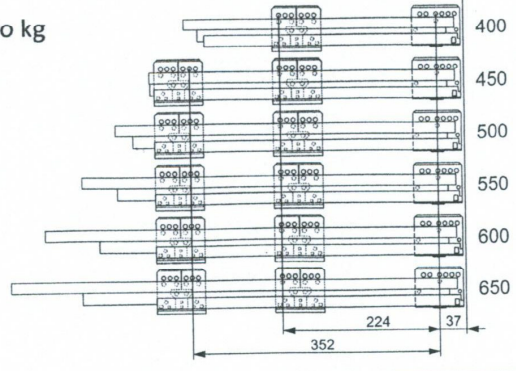

All errors and omissions excepted

Minimum installation depth = Nominal length of runner

Inset drawer = NL + 9

- NL Nominal length of runner
- LW Inside cabinet width
- KV Front edge of cabinet
- RS Set back of runner
- SRW Steel drawer back