

Components

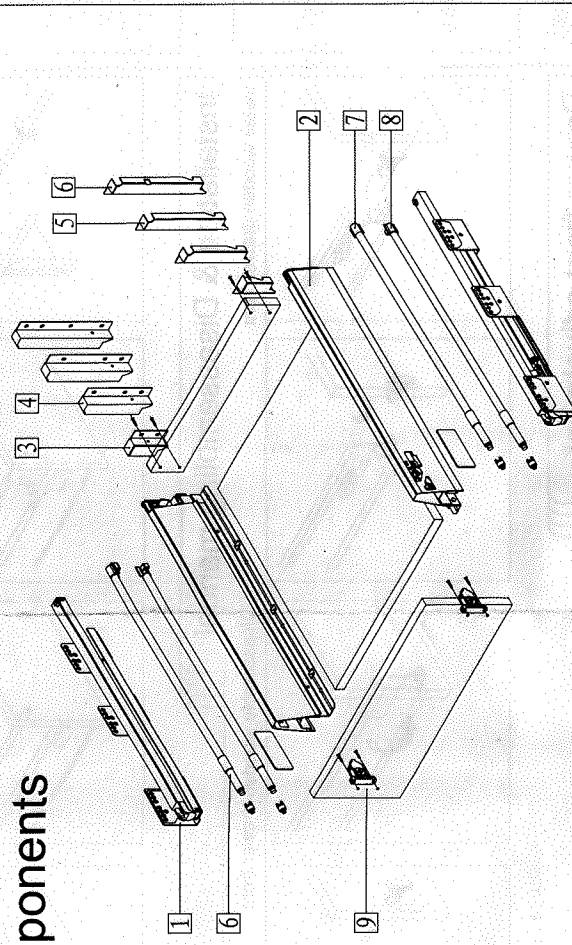

Item No.	Nominal length	Internal drawer length	Min. installation length of drawer
908SH-270	270mm	244mm	280mm
908SH-300	300mm	274mm	310mm
908SH-350	350mm	324mm	360mm
908SH-400	400mm	374mm	410mm
908SH-450	450mm	424mm	460mm
908SH-500	500mm	474mm	510mm
908SH-550	550mm	524mm	560mm

- 1. Cabinet profiles: (L/R)
- 2. Drawer profiles: (L/R)
- 3, 4. Rear connecting bracket
- 5, 6. Rear connecting bracket
- 7. Gallery tube
- 8. Middle tube
- 9. Front fixing brackets

B140 Installation dimensions

Assembling dimensions of cabinet

Front fixing bracket

Drilling hole size on drawer front

Drawer back

B164 Installation dimensions

Assembling dimensions of cabinet

Front fixing bracket

Drilling hole size on drawer front

Drawer back

B204 Installation dimensions

Assembling dimensions of cabinet

Front fixing bracket

Drilling hole size on drawer front

Drawer back

B86 Installation dimensions

Assembling dimensions of cabinet

Front fixing bracket

Drilling hole size on drawer front

Drawer back

B120 Installation dimensions

Assembling dimensions of cabinet

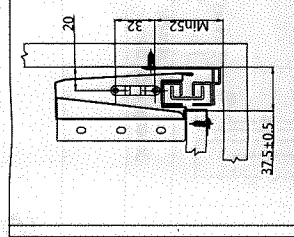
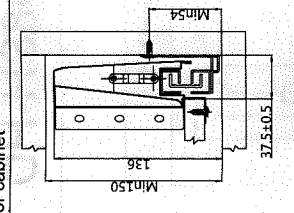

Drilling hole size on drawer front

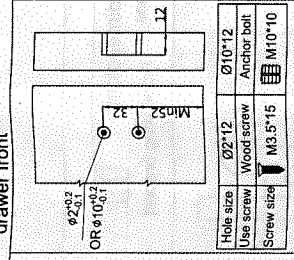

Drawer back

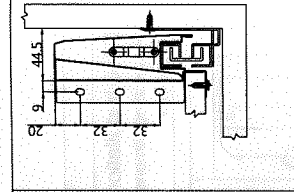

Bottom and back panels measurement

16mm Thickness panel
LW: Internal cabinet width

1 Back panel height (Refer to *)
Back panel length=LW-89±0.5

2 Bottom panel width=LW-75±0.5
Bottom panel length=Nominal length-7mm

3 Long tube=LW-71±0.5

4 Aluminium front length=LW-87±0.5

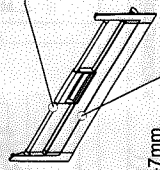

Item No.	B-66	B-120	B-140	B-164	B-204
Back panel height	70	104	124	148	188

Install assembly

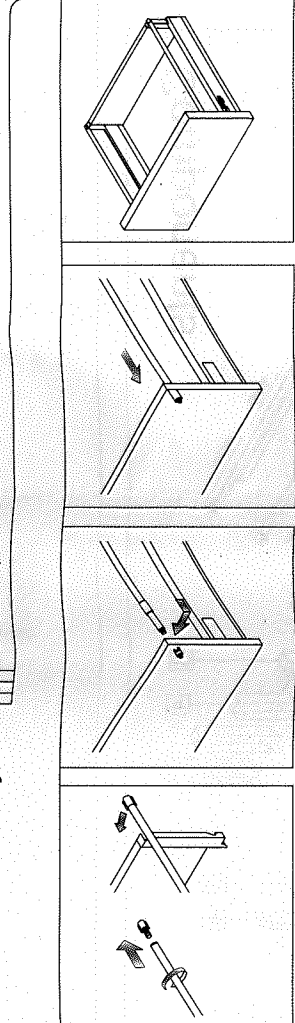

Installation & Disassembling manual

Install wooden drawer front

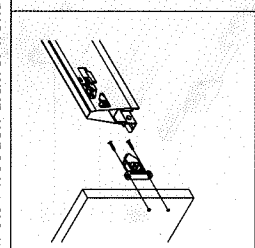

Disassemble wooden drawer front

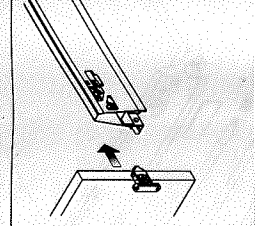

Slide installation

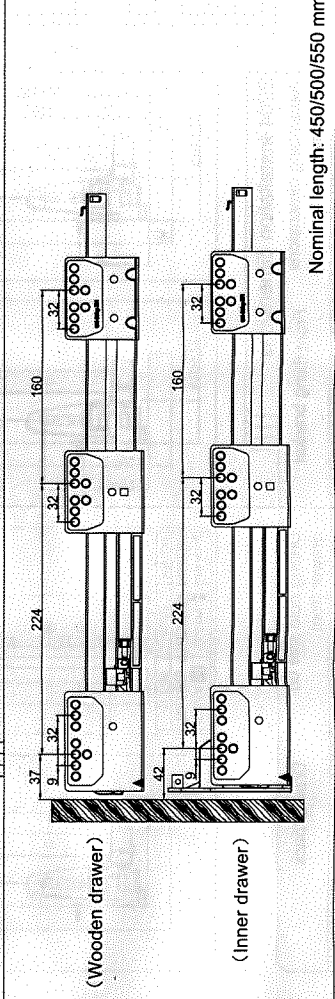

Nominal length: 450/500/550 mm

(Wooden drawer)

(Inner drawer)

Drawer front adjustment

Wooden drawer front height adjustment: ±2mm

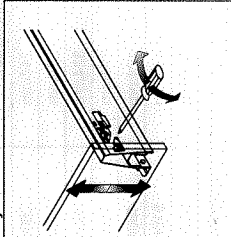

Drawer front right adjustment: 1mm

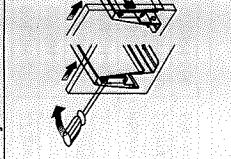

Drawer front left adjustment: 1mm

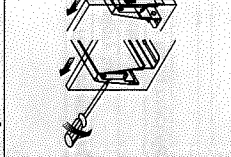

Gradient adjustment

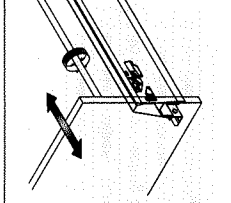

Drawer assembly

Install back panel

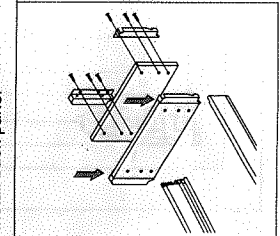

Install bottom panel

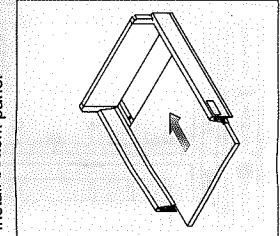

Install drawer front

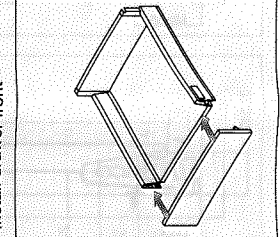

Install screw for bottom panel

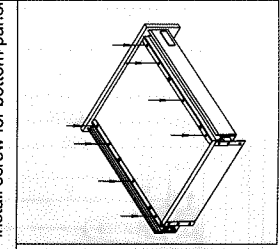

Install & Dismantle of drawer

1. Sliding out the slides

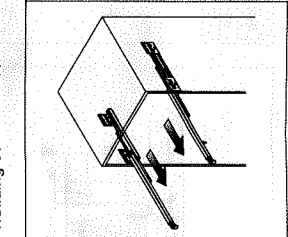

2. Method 1: put the drawer from the top onto the slide

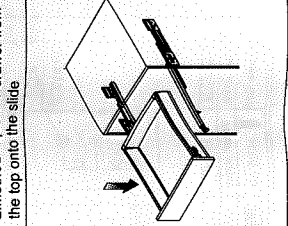

3. Method 11: put the drawer from the front onto the slide

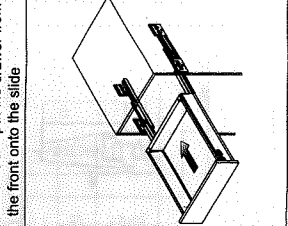

4. Lift the drawer up for dismantle

